

Dock and Charge Multi-Enclosure Installation and User Guide

NOTE: In case of device change, please contact Ergonomic Solutions Sales Support for available conversion kits.

Key management

Available online key management service and additional information through:

www.spacepoleregisterandretrieve.com

Our Register & Retrieve™ lock registration suite empowers administrators to manage their lock programmes and ensure staff benefit from support services without needing to contact their administrator.

It allows administrators to:

- Register locks
- Manage all locks programmes
- Record lock ownership
- Find the owners of lost keys
- Reassign locks to new users
- Create user accounts

It allows individuals to:

- Order replacement keys
- Retrieve stored combination codes
- Validate account and keycode details
- Update their personal details

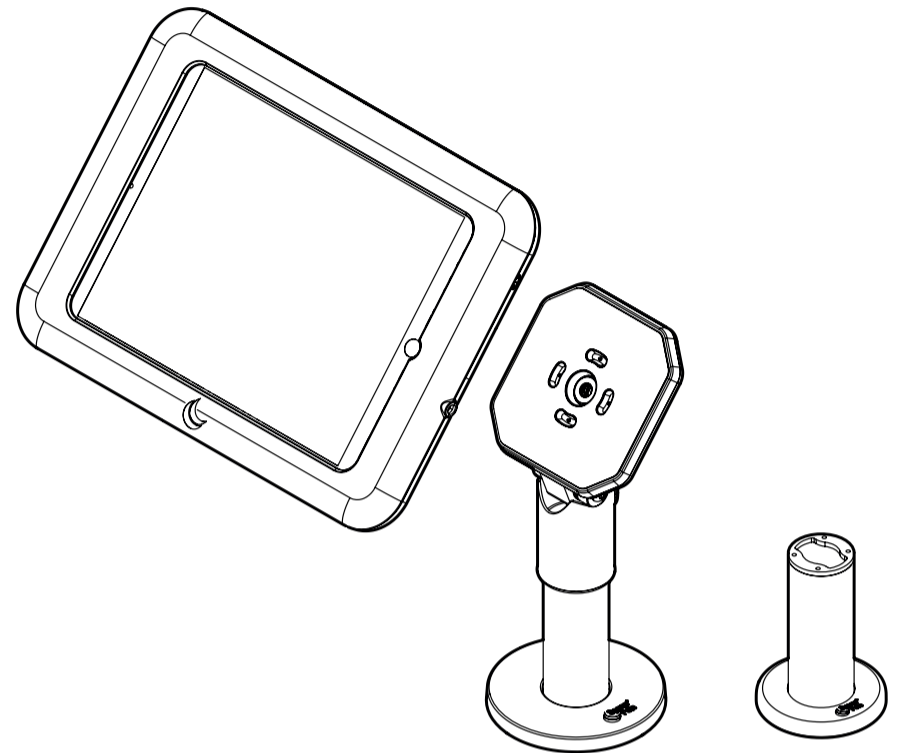

Keyed Solutions Available

Master Keyed

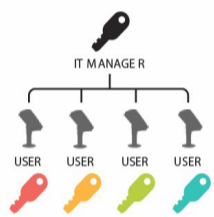

Supervisor Keyed

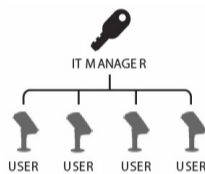

Keyed Alike

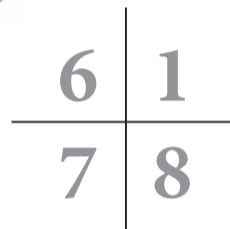
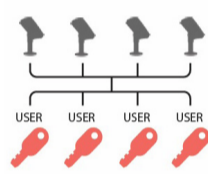

MK15-0279 version 1.0 05/2020

Important information

- Ergonomic Solutions warrants this product to be free from defects in materials in workmanship for one year.
- The guarantee does not cover accidental damage, however caused, wear and tear, or negligence.
- The guarantee will be rendered invalid if the product is re-sold or is damaged through any adjustment, modification or repair not authorised by us.
- Specifications are subject to change without notice.
- The manufacturer disclaims any liability for the incidental or consequential damages.
- The guarantee is in addition to and does not diminish your statutory or legal right.
- Only use in indoor environments.
- When cleaning, only use dry cloth, microfibre suggested.

WARNING: A WARNING indicates a potential for property damage, personal injury, or death.

WARNING: Use only provided Power Supply with product.

WARNING: Use only provided MicroUSB cables for the internal tablets connections.

WARNING, POWER SUPPLY: Connected equipment must be double isolated, class II, Safe Extra Low Voltage (SELV) & Limited Power as defined by IEC60950-1.

WARNING: Do not use your equipment on a wet environment. Protect equipment from liquid intrusion.

WARNING: If any internal components can be seen through damaged portions, or if smoke or unusual odours are detected, disconnect the device from the electrical outlet and contact Ergonomic Solutions Sales support.

WARNING: The mains socket-outlet shall be installed near the equipment and shall be accessible.

Waste Electrical and Electronic Equipment (WEEE) Directive
In the European Union, this label indicates that this product should not be disposed of with household waste. It should be deposited at an appropriate facility to enable recovery and recycling.

Registration, Evaluation, Authorization of Chemical (REACH)
REACH is the European Union (EU) chemical substances regulatory framework.

The Restriction of Hazardous Substances Directive 2002/95/EC, (RoHS 1)
This product is compliant with the RoHS Directive (RoHS 1)

NOTE:

This device complies with Part 15 of the FCC Rules. Operation is subject to the following two conditions: (1) This device may not cause harmful interference, and (2) this device must accept any interference received, including interference that may cause undesired operation.

1a Counter Mounting

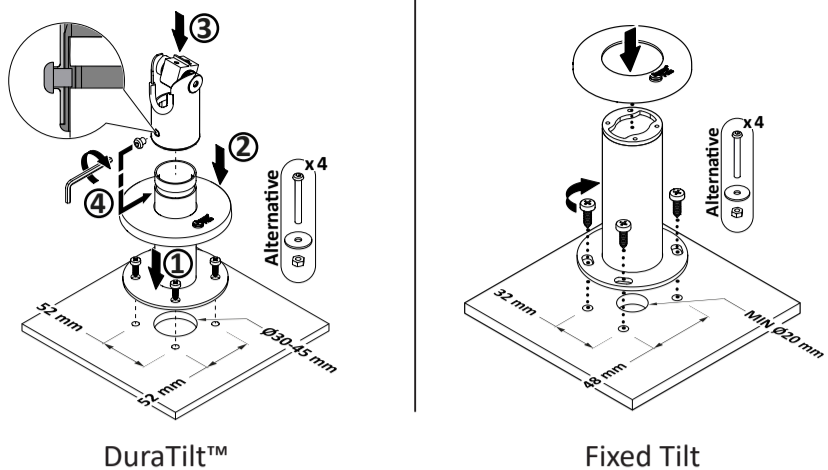

2 Dock assembly on DuraTilt™ and fixed tilt

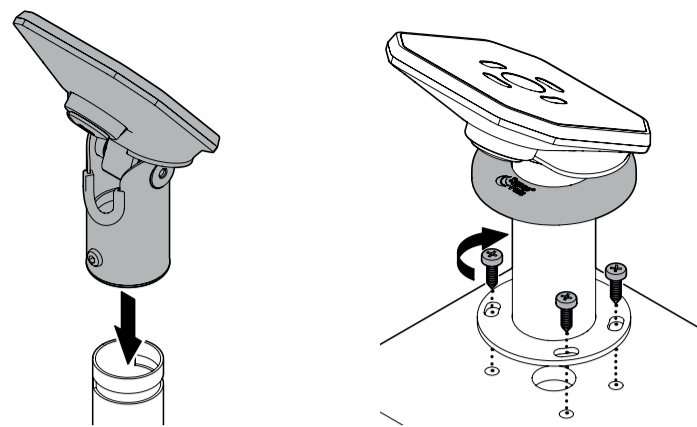

1b Floor Mounting (fixed tilt)

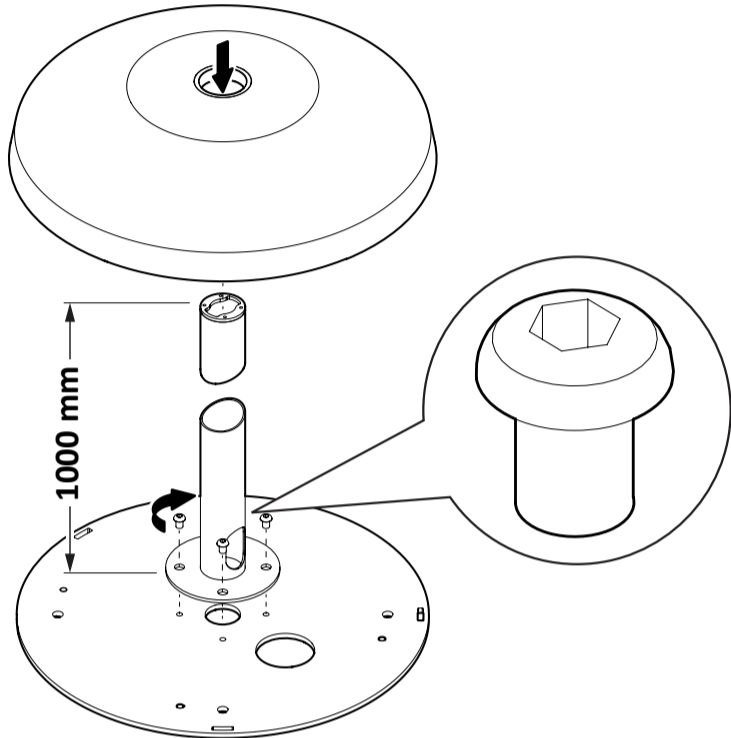

3 Multi-Enclosure assembly

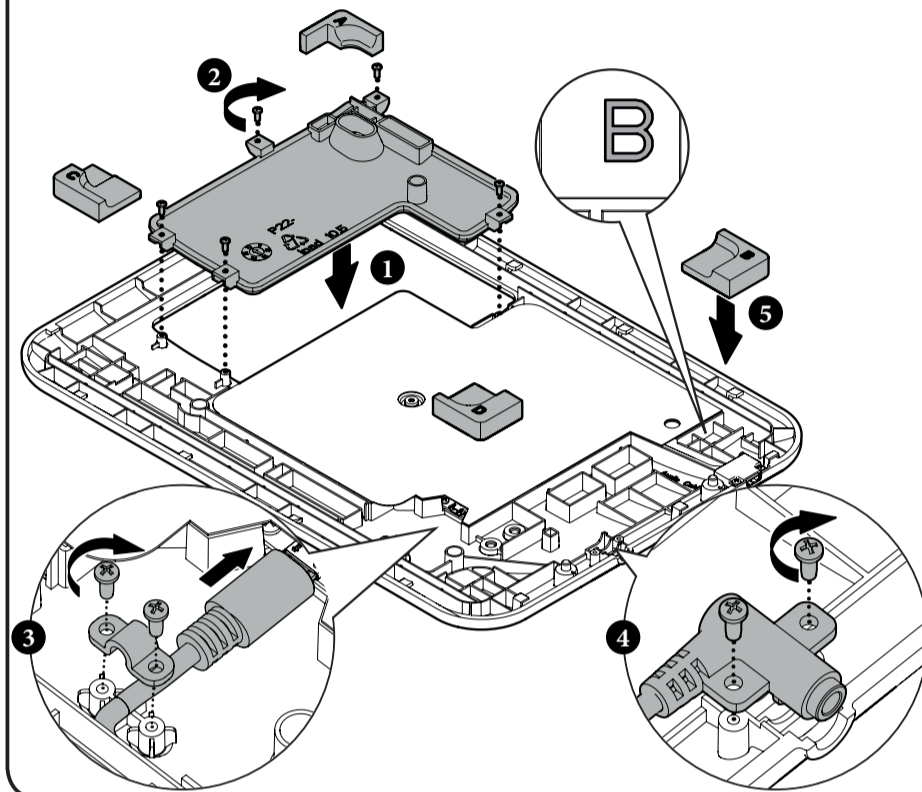

2 | 3
4 | 5

4 Multi-Enclosure tablet mounting and securing

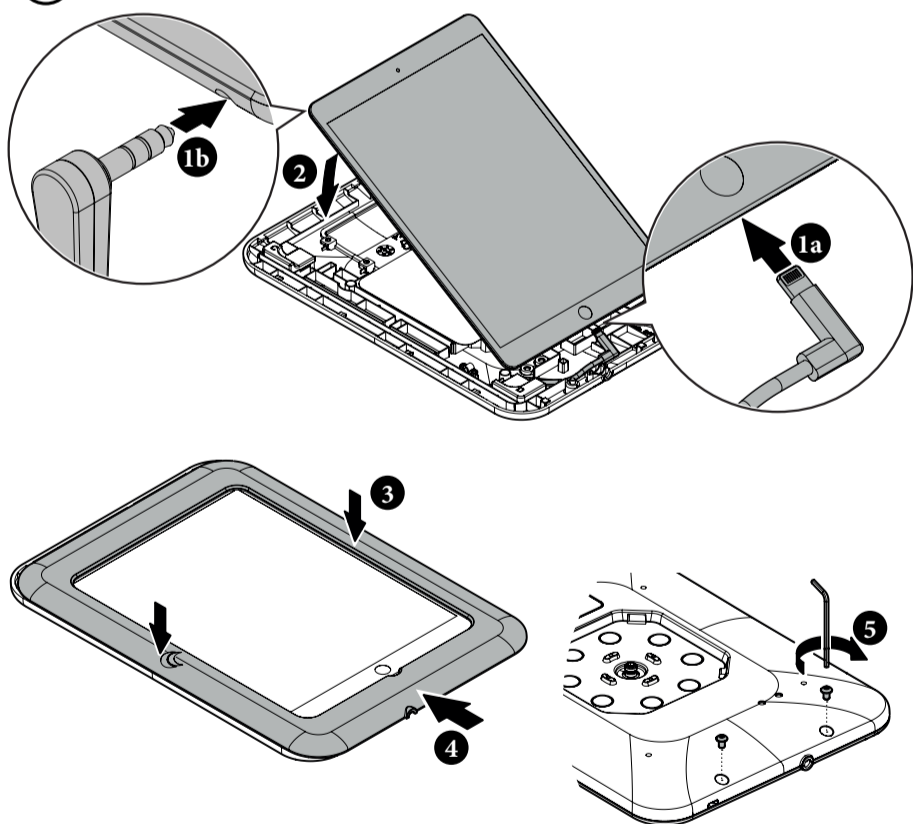

6 Locking and unlocking

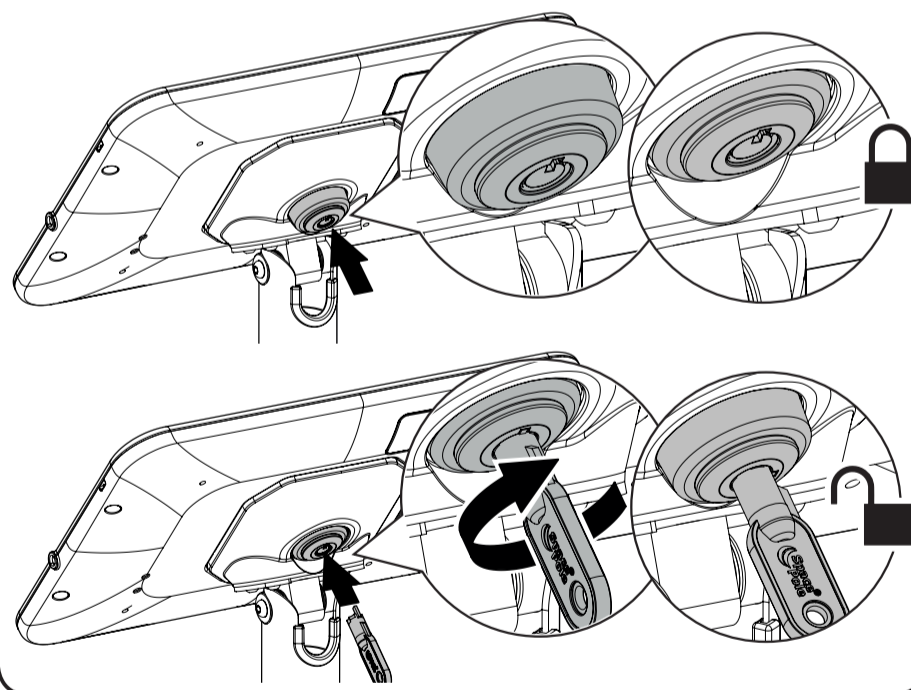

5 Multi-Enclosure docking, magnetic assist

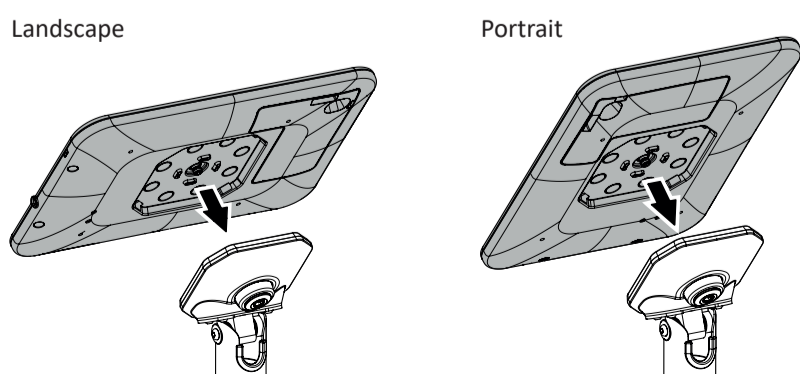

Mounting points for hand and shoulder straps

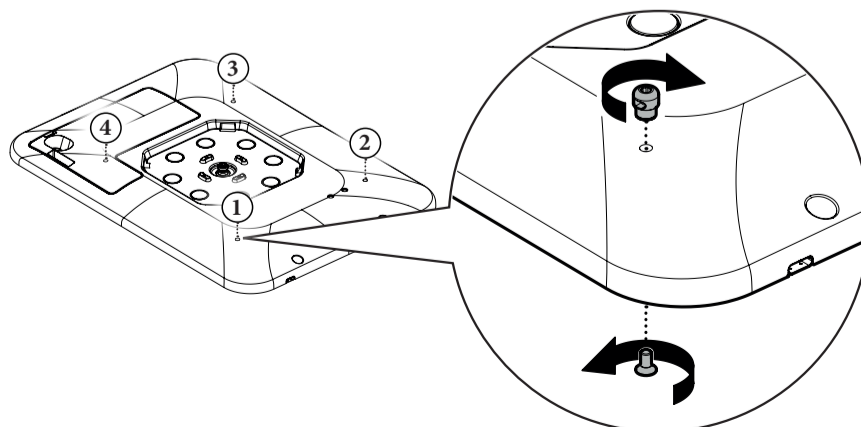

! Assemble the anchors before inserting the tablet!